



# Titan Electric

## BIG TEN CONFERENCE HEADQUARTERS



Titan Electric completed the new Big Ten Conference Headquarters building. Located within Rosemont's booming entertainment district, the 3-story, 50,800 square foot office complex features a 3,500 square foot interactive multimedia museum on the first floor, including electronic games and decades of vintage and current video highlights.

The second floor is comprised of meeting space including state-of-the-art conferencing capabilities for athletic and academic meetings. The third floor features administrative offices and an officiating command center providing monitors and video feeds for conference officials viewing athletic events real-time.

Titan's involvement was complete turn-key electrical and low voltage installation including:

- An extensive AV system featuring TV mounts and monitors, projectors and screens, video conferencing equipment, speakers, microphones, AV cabinets and equipment
- Audio visual cabling including Cat6, Coaxial, HDMI, VGA and speaker
- A 40-foot custom chandelier fixture featuring spiral pendants hanging as low as 25 feet from the ceiling
- A custom shade system with one-of-a-kind control panel and exterior lighting to match the trellis design near main entrance

Titan also provided base building power for Fogo de Chao, a 10,000 square-foot Brazilian steakhouse located on the first floor adjacent to the Big Ten. Leopardo Construction was the general contractor for the project with architectural services provided by RATIO Architects.

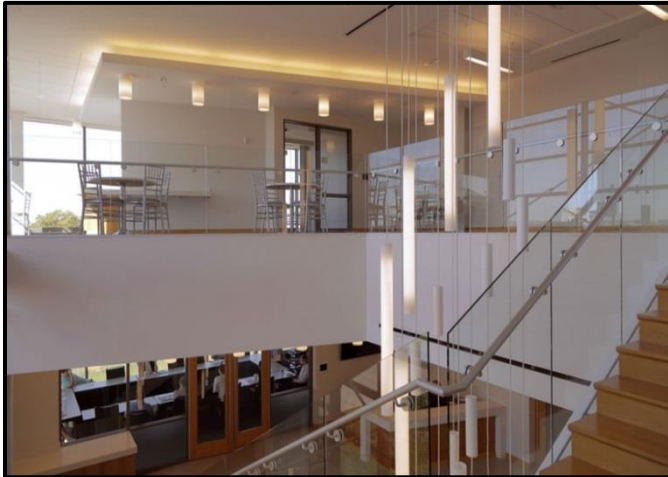

*POWERING THE FUTURE*