



# Titan Electric

## CENTRAL DUPAGE HOSPITAL BED PAVILION



Titan Electric was selected by Central DuPage Hospital to provide electrical services for its Bed Pavilion expansion and renovation project in Winfield, IL. CDH achieved LEED Silver Certification upon completion of the project, implementing items such as Seismic Bracing throughout.

The 3-wing, five-story, 276,000 square foot facility contains 202 private patient rooms, featuring televisions and work stations with Internet access. The building also includes six new ambulance bays, administrative offices, an auditorium and a 250-person conference room.

Titan Electric's involvement included the following:

- High voltage distribution and feeders including switch gear, panels, isolation equipment, emergency power, and power and conduit for over 1,300 fixtures
- 1,700 lighting and power devices
- Low Voltage lighting controls interfaced with BAS
- Ice and snow melt system for gutters and walkways
- Low Voltage cable tray throughout
- Category 6A VOIP, security and TV coaxial cabling
- Nurse call system
- Build-out of 15 computer rooms with redundant air-blown fiber optic cabling and copper backbone

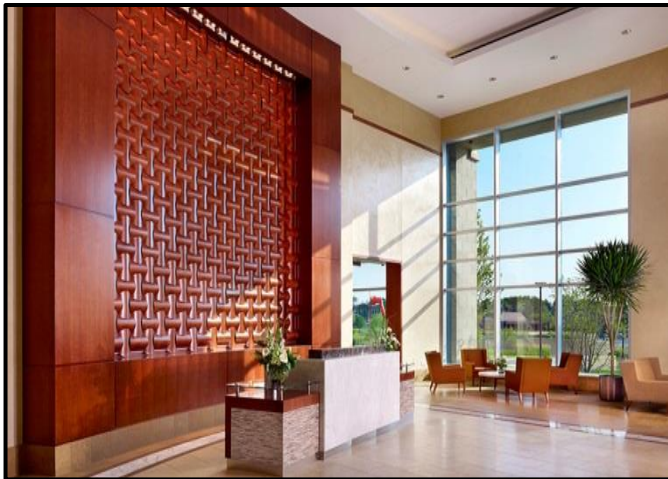

Titan also helped with the renovation of the Emergency Room, implementing infectious control procedures during construction. Responsibilities included an extension of the Bed Tower and an upgraded Category 6A structured cabling system. Titan implemented the use of 3D BIM coordination to synchronize the installation process with all the trades.

Pepper Construction was the general contractor for the project with architectural services provided by RTKL.



*POWERING THE FUTURE*